

Suburb Report

Footscray VIC 3011



Footscray VIC 3011



The size of Footscray is approximately 5 square kilometres.

It has 11 parks covering nearly 11.4% of total area.

The population of Footscray in 2011 was 13,202 people.

By 2016 the population was 16,336 showing a population growth of 23.7% in the area during that time.

The predominant age group in Footscray is 20-29 years.

Households in Footscray are primarily childless couples and are likely to be repaying \$1800 - \$2399 per month on mortgage repayments.

In general, people in Footscray work in a professional occupation.

In 2011, 42% of the homes in Footscray were owner-occupied compared with 36.6% in 2016.



House
Current Median

\$826,000



Unit
Current Median

\$402,500



Listings
last month

114

Recent Activity

Total sales
last 12 months

276

Why is recent activity important to me?

Recent sales activity provides insight into the current market condition. Many more sales than listings may indicate an under-supplied market, while conversely, more listings could indicate an over-supplied market with buyers in the driving seat.



Number Sold by Price (12 months)

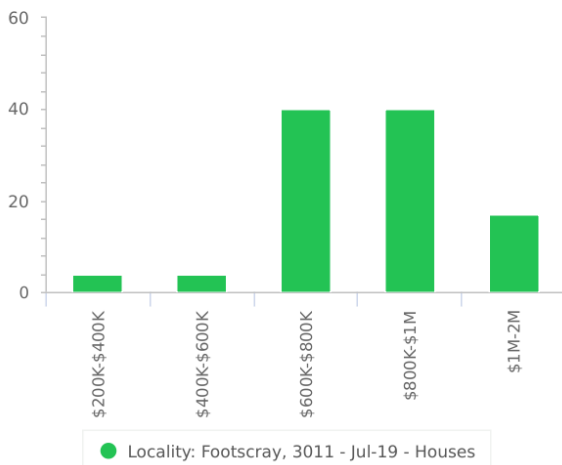

Number Sold by Price (12 months)

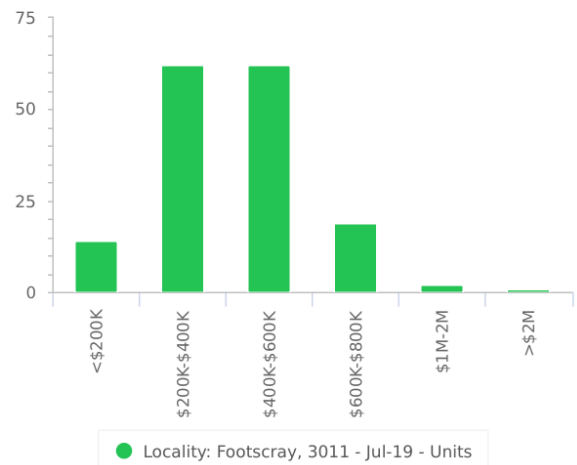

Median Sale Price (12 months)



Median Sale Price (12 months)



Recent Sales

UNIT

2 BED 2 BATH 1 CAR

105/21 GORDON STREET
FOOTSCRAY VIC 3011

\$465,000

26/10/19

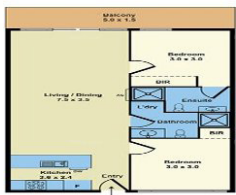

Reserve Conditions
(Check for Particulars)

Oct 19 CoreLogic



UNIT

1 BED 1 BATH 1 CAR

7/97 COWPER STREET
FOOTSCRAY VIC 3011

\$300,000

23/10/19

UNIT
3 BED 2 BATH 2 CAR
8/12 ELEANOR STREET
FOOTSCRAY VIC 3011

\$652,000

26/10/19



HOUSE

2 BED 1 BATH 2 CAR

10 CORAL AVENUE
FOOTSCRAY VIC 3011

\$855,000

26/10/19



UNIT

1 BED 1 BATH 4 CAR

20 DROOP STREET
FOOTSCRAY VIC 3011

\$2,000,000

24/10/19

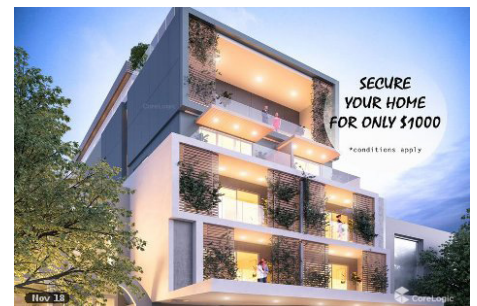

SECURE
YOUR HOME
FOR ONLY \$1000
*conditions apply

UNIT

2 BED 1 BATH 1 CAR

6/11 VICTORIA STREET
FOOTSCRAY VIC 3011

\$545,000

21/10/19

STATEMENT OF INFORMATION
Section 32 of the Estate Agents Act 1980

93 CRESWICK STREET, FOOTSCRAY, VIC 3011
Indicative Selling Price for the purpose of this advertisement: **\$799,000**
Single Price: **\$799,000**
Provided by: Media Department, Sotheby's International Realty

MEDIAN SALE PRICE
FOOTSCRAY, VIC, 3011
Suburb's Median Sale Price (Houses): **\$790,000**
By: 2018-01-01 to 2018-06-30
Provided by: **procbroker**

COMPARABLE PROPERTIES
The seller agent or agent's representative reasonably believes that these three comparable properties were sold within two kilometers of the property for sale in the last six months.

UNIT

2 BED 2 BATH 0 CAR

93 CRESWICK STREET
FOOTSCRAY VIC 3011

\$799,000

19/10/19

UNIT

1 BED 1 BATH 1 CAR

212/1 MORELAND STREET
FOOTSCRAY VIC 3011

\$400,000

19/10/19

Oct 19 has been created on 07/10/2019 by Sotheby's International Realty. Property Data Software Pty Ltd 2019 - www.era.com.au



HOUSE
3 BED 1 BATH 1 CAR
41 DUDLEY STREET
FOOTSCRAY VIC 3011
\$912,000
19/10/19



UNIT
2 BED 2 BATH 2 CAR
102/1 MORELAND STREET
FOOTSCRAY VIC 3011
\$690,000
19/10/19



UNIT
2 BED 2 BATH 1 CAR
59 DROOP STREET
FOOTSCRAY VIC 3011
\$515,000
16/10/19



UNIT
1 BED 1 BATH 1 CAR
1/29 ELDRIDGE STREET
FOOTSCRAY VIC 3011
\$250,000
18/10/19

Recent Listings



UNIT

1 BED 1 BATH CAR

203/188 BALLARAT ROAD
FOOTSCRAY VIC 3011

\$362,000



UNIT

1 BED 1 BATH 1 CAR

612/59 PAISLEY STREET
FOOTSCRAY VIC 3011

\$330,000 TO \$360,000



UNIT

1 BED 1 BATH 1 CAR

319/1 MORELAND

STREET

FOOTSCRAY VIC 3011

**PRICE: \$350,000-
\$385,000**



HOUSE

3 BED 1 BATH 1 CAR

5 NAISMITH STREET
FOOTSCRAY VIC 3011

AUCTION



UNIT

3 BED 2 BATH 4 CAR

26B CORAL AVENUE
FOOTSCRAY VIC 3011

**\$699,000 PRICED
TO SELL!**



HOUSE

2 BED BATH CAR

5 COWARD STREET
FOOTSCRAY VIC 3011

Rental Statistics



Median Rental Price

\$490 /w



Rental Yield

3.35%



Number of Rentals

263

Median Weekly Rent Trends

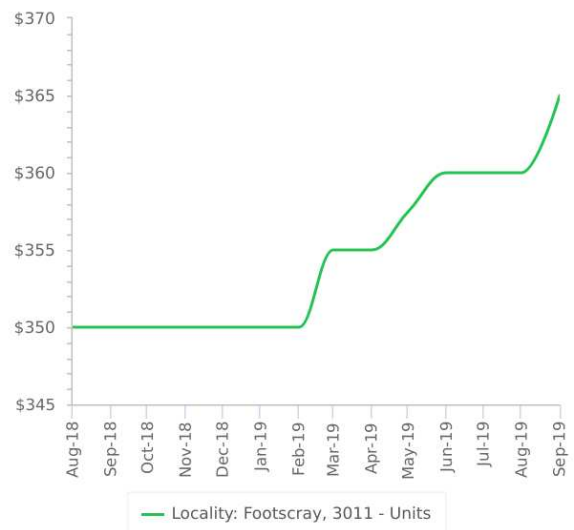



Compton Green
HOBSONS BAY t. 03 9397 1600
INNER WEST t. 03 9314 1188

comptongreen.com.au

Prepared on 1 Nov 2019 by

Sales results and median prices are based on the latest statistical period available (1 Aug - 31 Jul 2019).

© 2019 Copyright RP Data Pty Limited, Local, State, Commonwealth Govt. All rights reserved. No reproduction, distribution, or transmission of the copyrighted materials at this site is permitted. The information provided is deemed reliable but not guaranteed.

© The State of Queensland (Department of Environment and Resource Management) 2012. Based on data provided with the permission of the Department of Natural Resources and Mines: [QVAS 2012]). The Department of Environment and Resource Management makes no representations or warranties about accuracy, reliability, completeness or suitability of the data for any particular purpose and disclaims all responsibility and all liability (including without limitation, liability in negligence) for all expenses, losses and damages (including indirect or consequential damage) and costs which might be incurred as a result of the data being inaccurate or incomplete in any way and for any reason.